

AGENDA MANAGEMENT SHEET

Decision Making Session

**Portfolio Holder (Resources) &
Portfolio Holder (Customers, Workforce and
Partnerships) Decision Making Session**

Date of Decision

18 September 2009

Report Title

**Developer Funded Scheme at Kingsbury Mill
in Kingsbury**

Summary

This report seeks Cabinet approval to add the project to the 2009/10 Capital Programme to provide a new footway and widen the carriageway at Kingsbury Mill.

For further information please contact

Chris Nason
Group Engineer, Design Services
Tel: 01926 412088
chrisnason@warwickshire.gov.uk

Would the recommended decision be contrary to the Budget and Policy Framework?

No

Background Papers

Environment and Economy Directorate Design Services notification on file L210 (A).

CONSULTATION ALREADY UNDERTAKEN:-

Details to be specified

Other Committees

☐

.....

Local Member(s)

(With brief comments, if appropriate)

☒

Councillor B Moss

Other Elected Members

☒

Councillor J Appleton
Councillor R Chattaway
Councillor C Davis
Councillor M Gittus

} for information

Cabinet Member

(Reports to The Cabinet, to be cleared with appropriate Cabinet Member)

☒

Councillor A Cockburn – for information.
Councillor M Heatley
Councillor H Timms

Chief Executive

☐

.....

Legal	<input checked="" type="checkbox"/> I Marriott – Comments noted. B Jukes
Finance	<input checked="" type="checkbox"/> D Clarke – no comments to make.
Other Chief Officers	<input type="checkbox"/>
District Councils	<input type="checkbox"/>
Health Authority	<input type="checkbox"/>
Police	<input type="checkbox"/>
Other Bodies/Individuals	<input type="checkbox"/>

FINAL DECISION **YES/NO** *(If 'No' complete Suggested Next Steps)*

SUGGESTED NEXT STEPS :

Details to be specified

Further consideration by this Committee	<input type="checkbox"/>
To Council	<input type="checkbox"/>
To Cabinet	<input type="checkbox"/>
To an O & S Committee	<input type="checkbox"/>
To an Area Committee	<input type="checkbox"/>
Further Consultation	<input type="checkbox"/>

**Portfolio Holder (Resources) & Portfolio Holder (Customers,
Workforce and Partnerships) Decision Making Session
- 18 September 2009**

Developer Funded Scheme at Kingsbury Mill, Kingsbury

Report of the Strategic Director for Environment and Economy

Recommendation

That the project to provide a new footway and widen the carriageway at Kingsbury Mill in Kingsbury be included in the 2009/10 capital programme at an estimated cost of £95,000 subject to a Section 278 Agreement which provides for 100% funding of the project being signed with the developer.

1. Introduction

- 1.1 On 2 February 2009 Council reconfirmed that Cabinet can approve projects for addition to the capital programme provided that they cost less than £1.5 million and are fully funded from external grants, developer contributions or from revenue.

2. Kingsbury Mill, Kingsbury

- 2.1 The upgrading of an existing priority junction and footway at Kingsbury Mill in Kingsbury is required to comply with planning permission. There is a map showing the site referred to at **Appendix A**.
- 2.2 Subject to Portfolio Holder approval, the County Council will undertake the works at an estimated cost of £95,000 including fees, to be funded by the developer Walton Homes under a Section 278 agreement which is due to be signed in September 2009. Tenders are expected to be received in October 2009 and, subject to Portfolio Holder approval, works can commence in November 2009.

PAUL GALLAND
Strategic Director for Environment and Economy
Shire Hall
Warwick

September 2009

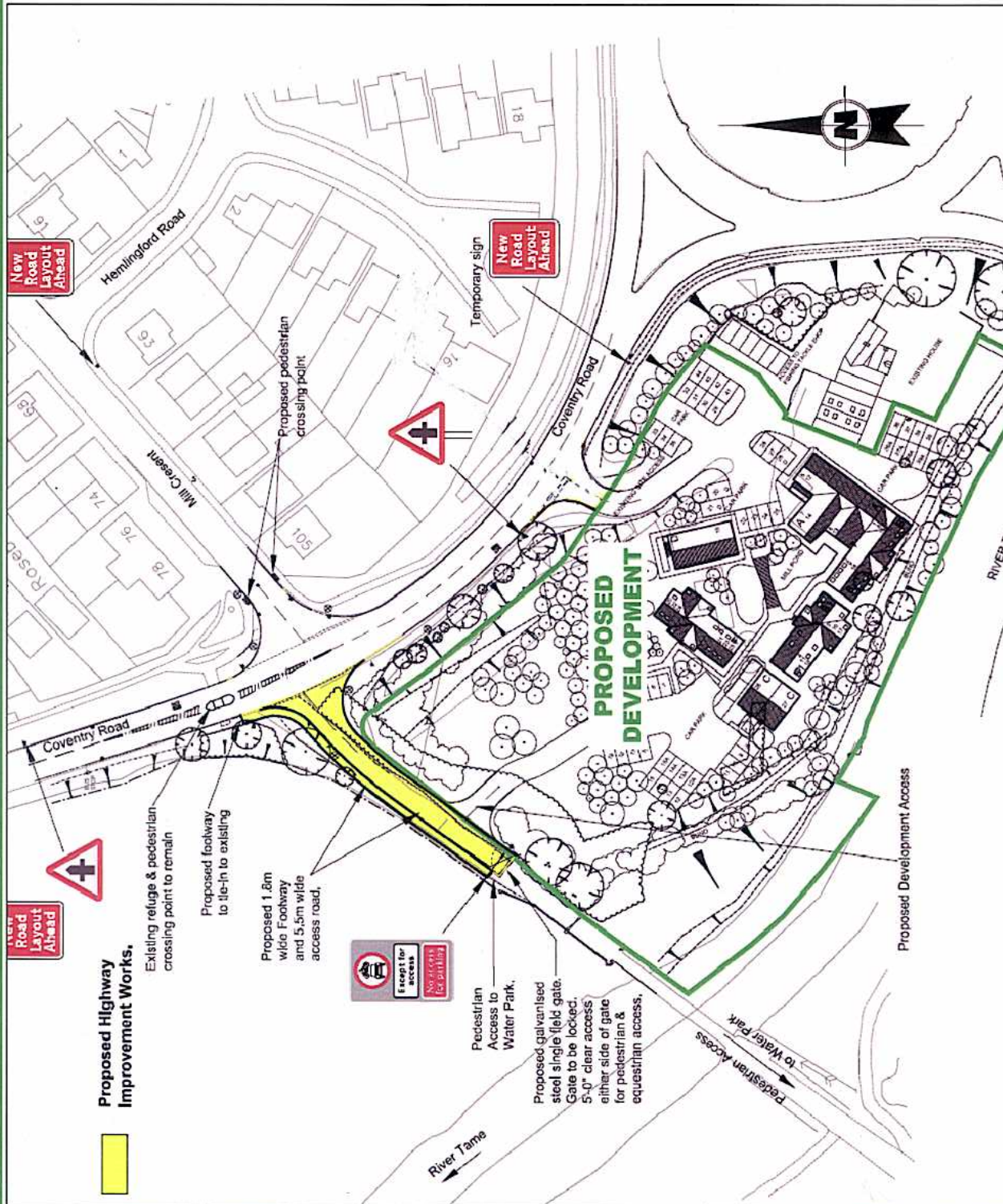

Scale: As Shown

Ref. No. 9.6.84

Drawn: JEM

Checked: JEM

QA Form 19
02/96

Portfolio Holder Decision - Making (Environment): 18 September 2009

Plan No.: Appendix A

Subject:

Kingsbury Mill S278

Appendix A



Environment and
Economy Directorate
Shire Hall, Warwick, CV34 4SX

This plot was produced from a digital source so may not be at true scale. It is the recipient's responsibility to confirm its accuracy.